



Rodney Powell
Edward H Perkins

By email:

Your Ref: RNP/ABW/H1419074
Our Ref: qA1316455 / R0035
Date: 21 February 2020

Dear Mr Powell,

**A40 LLANDDEWI VELFREY TO PENBLEWIN IMPROVEMENTS
MR WYNN EVANS GRIFFITHS,**

I refer to your correspondence dated 18 February 2020 in relation to the draft Statutory Orders associated with the Welsh Government's proposals for the A40 Llanddewi Velfrey to Penblewin ("the Scheme"). Thank you for confirming that your client wishes to withdraw his objection to the Scheme.

In line with point 1 of your correspondence, and in line with the commitment previously made in paragraphs 1.1 - 1.5 of my correspondence dated 13 January 2020, please find enclosed a Plan and Schedule displaying a proposed modification to the draft Compulsory Purchase Order (referenced as Modification 17).

The extent of plots 3/8 and 3/8a have now been reduced to omit the raised paved hardstanding outside your clients' property. The new boundary of plots 3/8 and 3/8a are based on a topographical survey which was undertaken in October 2019.

As well as the plan and schedule, please also find enclosed an acceptance pro-forma. I would be grateful if you could sign this pro-forma to confirm acceptance of the modification. This signed pro-forma would then be handed to the Inspector at the forthcoming Public Local Inquiry, which would show that your clients approve the proposed modification. Without the return of the signed pro-forma as proof of acceptance, the Inspector may not accept the modification proposal.

I would be grateful if you could return the signed pro-forma by Friday 28 February so that it may be presented to the Inquiry, which is Scheduled to start on Tuesday 10 March at Llanddewi Velfrey Village Hall.



Should you require clarification, or wish to discuss the above prior to responding, please do not hesitate to contact the project public liaison officer, Martin Gallimore, on A40enquiries@arup.com or

Yours sincerely



Mark Dixon
Project Director

Cc:
Wynn Evans Griffiths

Enclosures:
Modification Pro-forma
Modification 17 – Plan
Modification 17 – Schedule

A40 LLANDDEWI VELFREY TO PENBLEWIN IMPROVEMENTS

MODIFICATION ACCEPTANCE PRO-FORMA

MR WYNN EVANS GRIFFITHS,

In response to your correspondence dated 21 February 2020 regarding the proposed modification referenced as Modification 17, I confirm that:

- My client **accepts** the proposed modification

- My client **does not accept** the proposed modification

Signature _____

Printed Name _____

Date _____

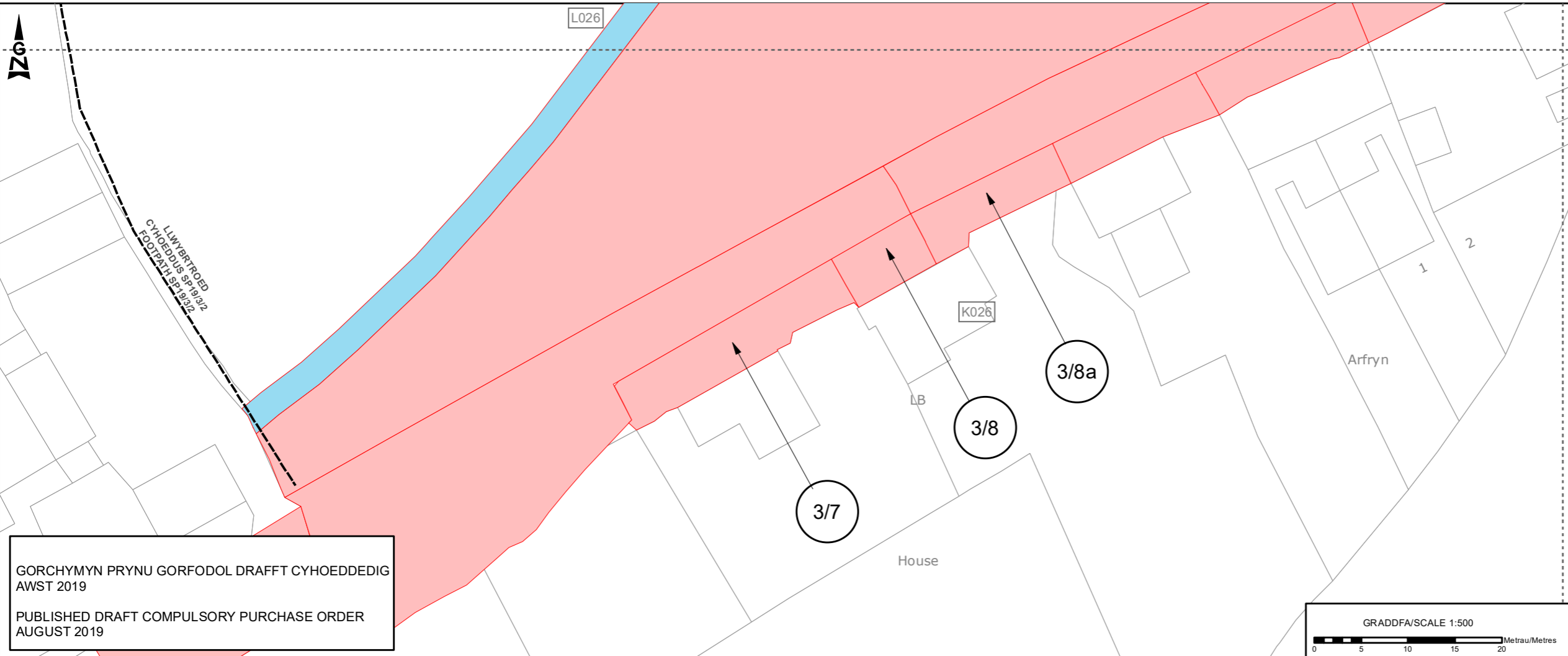

- ALLWEDD: KEY:**
- Hawliau Tramwy Cyhoeddus*
Public Rights of Way
 - Ffin Cyngor Tref a Chymuned*
Town and Community Council Boundary
 - Title
Teitl
Title
 - Easement
Hawliau
Rights
 - 1/A Plot heb ei ddiwygio
Unamended Plot
 - 1/A Plot wedi ei ddiwygio
Amended Plot
 - M021 Rhifau tir caeedig pendol i'r cynllun
Enclosure numbers specific to the scheme



GORCHYMYN PRYNU GORFODOL GWEINIDOGION CYMRU (CEFNFFORDD LLUNDAIN I ABERGWAUN (YR A40) (LLANDEWI FELFFRE I BENBLEWIN)) 201-
 THE WELSH MINISTERS (THE LONDON TO FISHGUARD TRUNK ROAD (A40) (LLANDEWI VELFREY TO PENBLEWIN)) COMPULSORY PURCHASE ORDER 201-

GORCHYMYN PRYNU GORFODOL
 RHIF ADDASU 17
COMPULSORY PURCHASE ORDER
 MODIFICATION NUMBER 17

MODIFICATION 17 - SCHEDULE

SCHEDULE 1
LAND TO BE PURCHASED (EXCEPT EXCHANGE LAND) AND NEW RIGHTS

Table 1

Number on Map (1)	Extent, description and situation of the land (2)	Qualifying persons under paragraph 3 of Schedule 1 to the Acquisition of Land Act 1981 (3)			
		Owers or reputed owners	Lessees or reputed lessees	Tenants or reputed tenants (other than lessees)	Occupiers
IN THE COMMUNITY OF LAMPETER VELFREY IN THE COUNTY OF PEMBROKESHIRE					
3/7	132 square metres of half width of A40 Trunk Road located east of Glenfield and south west of Bethel Chapel. Enclosure Nos. K026	Maureen Ann Tinson and Paul Vivian Richardson			Maureen Ann Tinson and Paul Vivian Richardson
3/8	52 square metres of half width of A40 Trunk Road located east of Glenfield and south west of Bethel Chapel. Enclosure Nos. K026	Wynn Evans Griffiths			Wynn Evans Griffiths
3/8a	82 square metres of half width of A40 Trunk Road located east of Glenfield and south west of Bethel Chapel. Enclosure Nos. K026	Wynn Evans Griffiths			Wynn Evans Griffiths